



GILSON GRAY

LAW • PROPERTY • FINANCE

98 NORTHFIELD FARM AVENUE

Northfield, Edinburgh, EH8 7QZ



This three-bedroom main-door upper villa is attractively presented with stylish, contemporary interiors and forms part of an established residential development in the Northfield area of Edinburgh. It is sure to appeal to a wealth of buyers and benefits from close proximity to excellent amenities, including a convenience store just across the road, more extensive shopping within easy reach, primary and secondary schooling, transport links across the city, and scenic open spaces, including beautiful Figgate park. Extras: Integrated kitchen appliances comprising induction hob, oven, fridge freezer and washing machine which are all new. Please note, no warranties or guarantees shall be provided for the appliances.



FEATURES

- Main-door upper villa in Northfield
- Well-presented, contemporary interiors
- Private ground-floor entrance and first-floor hall
- Southeast-facing living room
- Modern dining kitchen with fitted seating
- Three well-proportioned bedrooms, all with built-in storage
- Stylish family bathroom with shower-over-bath and towel radiator
- Private, low-maintenance rear garden
- Double garage for private parking







"A THREE-BEDROOM MAIN-
DOOR UPPER VILLA WITH
CONTEMPORARY INTERIORS,
A DOUBLE GARAGE, AND A
PRIVATE REAR GARDEN"





EPC RATING:



COUNCIL TAX BAND:



VIEWINGS: by appointment with Gilson Gray on 0131 516 5366

Ground Floor
Approx. 3.6 sq. metres (38.8 sq. feet)

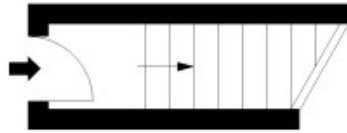

Double Garage
Approx. 21.5 sq. metres (231.4 sq. feet)

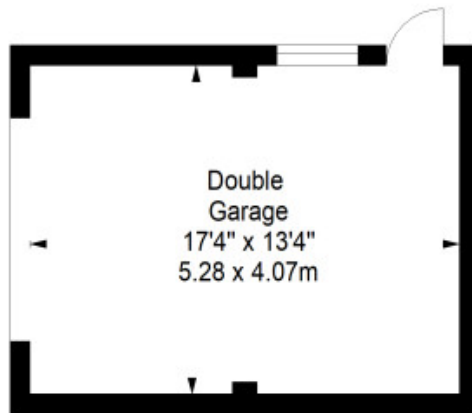

First Floor
Approx. 82.1 sq. metres (883.7 sq. feet)

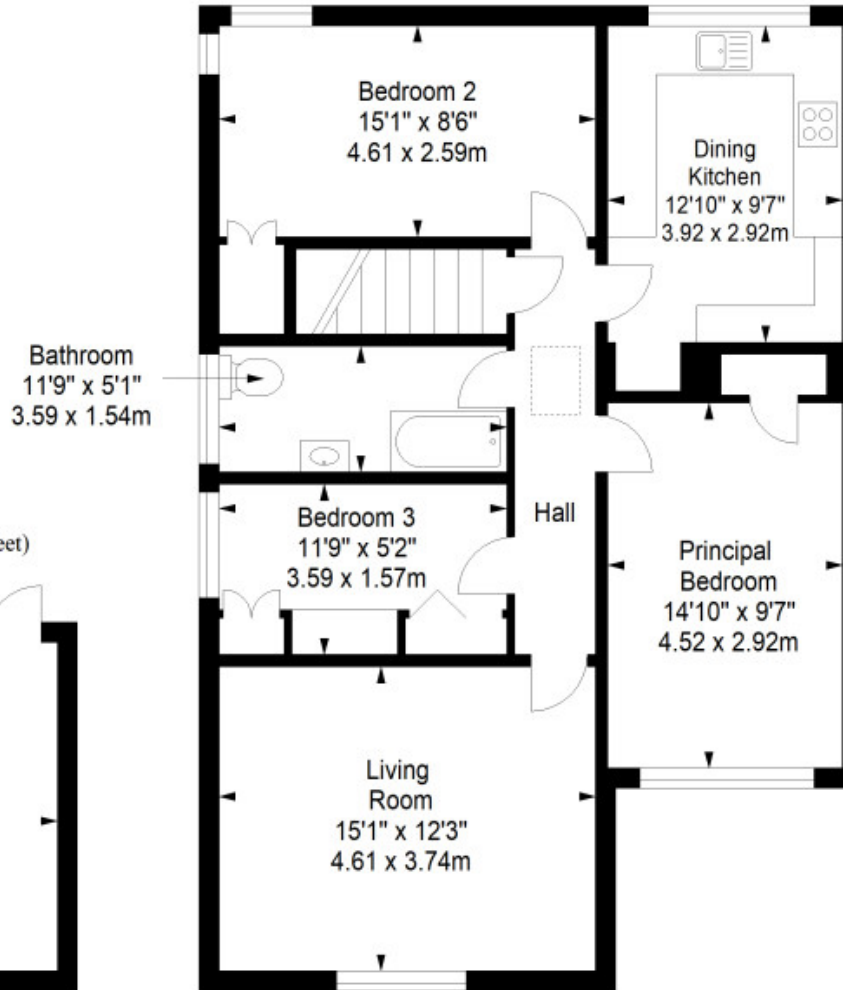

Total area: approx. 107.2 sq. metres (1153.9 sq. feet)



GILSONGRAY.CO.UK

EDINBURGH

29 Rutland Square
EH1 2BW
0131 516 5366



GLASGOW

160 West George Street
G2 2HQ
0141 530 2021



EAST LOTHIAN

33 Westgate
EH39 4AG
01620 893 481



DUNDEE

2 West Marketgait
DD1 1QN
01382 201 000



BORDERS

01890 880 008



@gilsongrayprop gilson gray property gilson gray property @gilsongrayprop

These particulars were prepared on the basis of our own knowledge of the local area and, in respect of the property itself, information supplied to us by our clients; all reasonable steps were taken at the time of preparing these particulars to ensure that all details contained in them were accurate. All statements contained in the particulars are for information only and all parties should not rely upon them as statements or representations of fact. In particular, (a) descriptions, measurements and dimensions, which may be quoted in these particulars are approximate only and (b) all references to conditions, planning permission, services, usage, constructions, fixtures and fittings and movable items contained in the property are for guidance only. Our clients may instruct us to set a closing date for offers at short notice and therefore if you wish to pursue interest in this property, you should immediately instruct your solicitor to note interest with us. Our clients reserve the right to conclude a bargain for the sale of the above subjects or any part thereof ahead of a notified closing date and will not be obliged to accept either the highest or indeed any offer for the above subjects or any part thereof. All measurements have been taken using a sonic tape and cannot be regarded as guaranteed given the limitations of the device. Services and/or appliances referred to in these particulars have not been tested and no warranty is given that they are in full working order.