



GILSON GRAY

LAW • PROPERTY • FINANCE

7/9 WESTERN HARBOUR MIDWAY,
Newhaven, Edinburgh, EH6 6LE



A generously spacious and smartly presented two-bedroom, second floor apartment set within this popular waterside development close to Newhaven tram stop, offering well-proportioned living space opening out to a large south-facing balcony. Western Harbour is a development of modern apartment buildings set on the shores of The Firth of Forth in the Newhaven area of the capital. It is a peaceful area benefiting from bracing sea air combining many local amenities with very good connections to the city centre. There is a large 24-hour Asda supermarket nearby, as well as a David Lloyd gym and tennis club, whilst there is a selection of shoreside restaurants and watering holes at picturesque Newhaven Harbour. The recently completed Newhaven tram extension means there are regular direct links to The Shore in Leith, the city centre, and beyond to Edinburgh International Airport. The North Edinburgh Cycle Network provides traffic-free bike routes around the city, and the motorist can find convenient links to the east and west via Seafield Road, or Queensferry Road.



FEATURES

- Second Floor Apartment In Sought-After Waterfront Development
- Entrance Hall
- Spacious Living Room
- South-Facing Balcony
- Large Contemporary Dining Kitchen
- Principal Bedroom With Built-In Wardrobes
- En Suite Shower Room
- Further Double Bedroom With Fitted Wardrobes
- Bathroom
- Utility Cupboard
- Two Further Large Storage Cupboards
- Lift
- Communal Gardens







"A GENEROUS TWO-BEDROOM SECOND-FLOOR APARTMENT, WHICH FORMS PART OF A SOUGHT-AFTER WATERSIDE DEVELOPMENT IN NEWHAVEN"





EPC RATING:

B

COUNCIL TAX BAND:

F

VIEWINGS: by appointment with Gilson Gray on 0131 516 5366

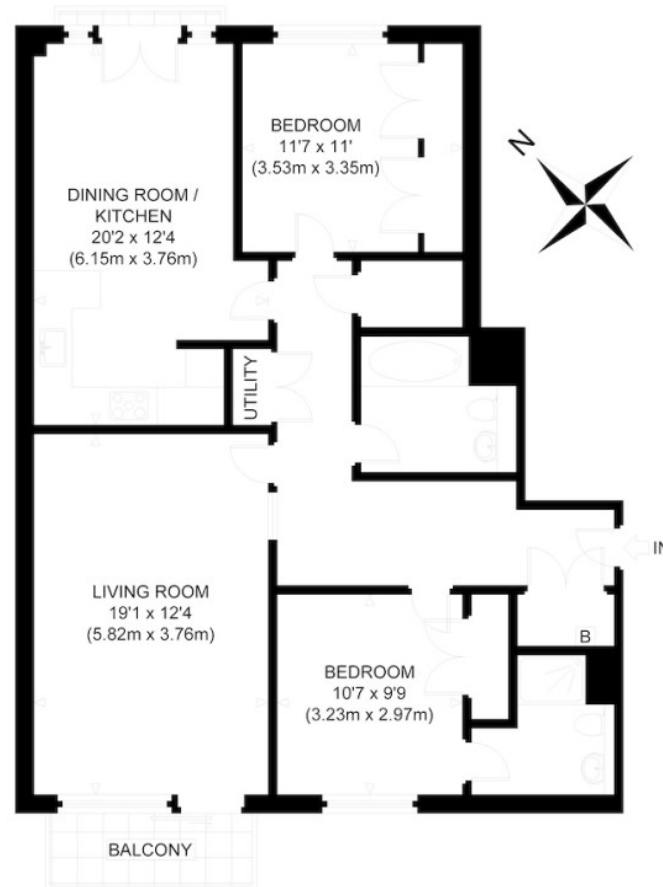

SECOND FLOOR
GROSS INTERNAL
FLOOR AREA 1044 SQ FT / 97.0 SQ M

WESTERN HARBOUR MIDWAY
NOT TO SCALE - FOR ILLUSTRATIVE PURPOSES ONLY
APPROXIMATE GROSS INTERNAL FLOOR AREA 1044 SQ FT / 97.0 SQ M
All measurements and fixtures including doors and windows
are approximate and should be independently verified.

Copyright © exposure
www.photographyandfloorplans.co.uk



GILSONGRAY.CO.UK

EDINBURGH

29 Rutland Square
EH1 2BW
0131 516 5366



GLASGOW

160 West George Street
G2 2HQ
0141 530 2021



EAST LOTHIAN

33 Westgate
EH39 4AG
01620 893 481



DUNDEE

2 West Marketgait
DD1 1QN
01382 201 000

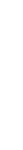

BORDERS

01890 880 008



@gilsongrayprop gilson gray property gilson gray property @gilsongrayprop

rightmove Zoopla.co.uk OnTheMarket

These particulars were prepared on the basis of our own knowledge of the local area and, in respect of the property itself, information supplied to us by our clients; all reasonable steps were taken at the time of preparing these particulars to ensure that all details contained in them were accurate. All statements contained in the particulars are for information only and all parties should not rely upon them as statements or representations of fact. In particular, (a) descriptions, measurements and dimensions, which may be quoted in these particulars are approximate only and (b) all references to conditions, planning permission, services, usage, constructions, fixtures and fittings and movable items contained in the property are for guidance only. Our clients may instruct us to set a closing date for offers at short notice and therefore if you wish to pursue interest in this property, you should immediately instruct your solicitor to note interest with us. Our clients reserve the right to conclude a bargain for the sale of the above subjects or any part thereof ahead of a notified closing date and will not be obliged to accept either the highest or indeed any offer for the above subjects or any part thereof. All measurements have been taken using a sonic tape and cannot be regarded as guaranteed given the limitations of the device. Services and/or appliances referred to in these particulars have not been tested and no warranty is given that they are in full working order.