









Offers Over

**£215,000**

## 10 Drum Brae Crescent

Drum Brae | Edinburgh | EH4 7SB

This impressive terraced villa with lovely private gardens forms part of an established residential area that is popular with professionals and families, close to excellent day to day amenities and well placed for commuting. The well-presented home benefits from gas central heating, double glazing, and on-street parking with early viewing highly recommended.

-  2 Bedrooms
-  1 Public Room
-  1 Bathroom
-  On-Street Parking
-  Front and Rear Gardens
-  EPC Rating – C
-  Council Tax Band - D



## Description

The accommodation, in brief, comprises; welcoming entrance hallway, spacious and bright reception room, stylish dining kitchen with appliances and door to rear garden, upper landing with hatch to partially floored attic, generously proportioned principal bedroom with built-in mirrored wardrobes, further good-sized double bedroom, and contemporary bathroom with modern three piece suite including electric shower over bath.



## Extras

All fitted floor coverings will be included in the sale together with the gas hob, oven, fridge/freezer and washing machine.

## Gardens & Parking

The private gardens are a real feature and the ideal space for outside dining/relaxing and for children to play. The fully enclosed rear is split into distinct sections with decking and neat lawn. The front is laid to neat lawn and ample unrestricted on-street parking can be found within the surrounding area.

## Viewing

By appointment through Neilsons 0131 625 2222.





## Location

Drum Brae a popular residential area well served by local retailers. The Gyle shopping Centre and Hermiston Gait are only a short drive away providing additional shops and services. Good schooling at all levels is available locally and the area is very well served by the public transport network linking with surrounding areas and the City Centre. Leisure and recreational opportunities include the Drum Brae and David Lloyd Leisure Centres, local golf courses, tennis club and the recently opened Drumbrae Library and Community Hub. Nearby Corstorphine offers a full range of banks, Post Office and restaurants, cafes and pubs, together with the attraction of Edinburgh Zoo. The area is ideal for commuters as links to the City Bypass, M8/M9, the Forth Road Bridge and Edinburgh International Airport are all close at hand.



Approx. Internal Area 67.63 Sq M / 728 Sq Ft.

Not to scale. For identification only.

© www.planography.co.uk 2024

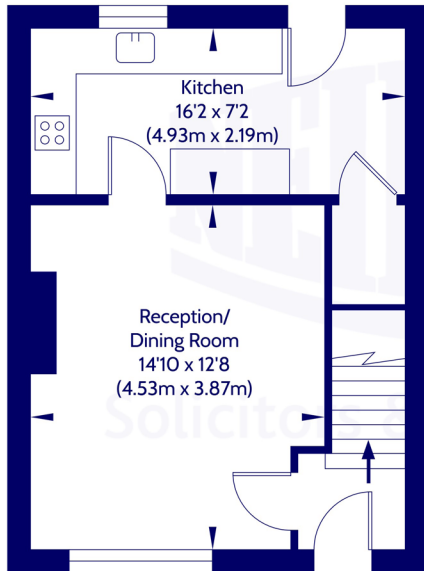

Ground Floor

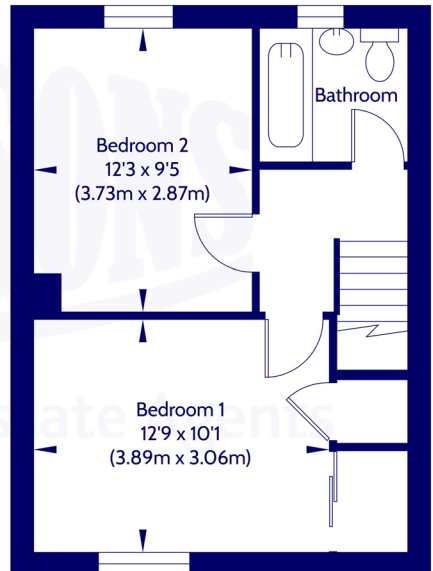

First Floor

Whilst we endeavour to ensure that our sales particulars are accurate and reliable, the following general points should be noted with regard to the extent of our investigations prior to marketing the property and therefore if any particular aspect is of crucial relevance to you, please contact this office for verification particularly if you are contemplating travelling some distance to view.

[1] All measurements have been taken using a sonic measuring device and there may be some minor fluctuations in measurements due to the limitations of the device.

[2] None of the items included in the sale of a working or running nature have been tested by us and this Firm gives no warranty as to their condition.

[3] Where alterations or improvements have been undertaken by the sellers or their predecessors, we have not specifically established that the renewal or replacement of any of the services or facilities have been whole or partial.

[4] Verification of Council Tax banding can be obtained from City of Edinburgh Council or Public Libraries.



Scan the QR code or [click here](#) for the virtual 360 tour, floor plan and further information.



Solicitors & Estate Agents

## Our Services:

- Full estate agency service
- Buying & Selling
- Buy to let advice
- Wills & Powers of Attorney
- Estate Planning
- Executries
- Powers of Attorney

For helpful, friendly, personal advice, get in touch.

✉ [mail@neilsons.co.uk](mailto:mail@neilsons.co.uk)

☎ 0131 625 2222

💻 [www.neilsons.co.uk](http://www.neilsons.co.uk)

### Head Office

138 St John's Road  
Edinburgh

### Property Department

142 St John's Road  
Edinburgh

### City Centre

2a Picardy Place  
Edinburgh

### South Queensferry

37 High Street  
South Queensferry

### Bonnyrigg

72 High Street  
Bonnyrigg

