



33 GOGARLOCH SYKE

SOUTH GYLE, EDINBURGH, EH12 9JD



1 PUBLIC



2 BED



1 BATH



VMH SOLICITORS

0131 622 2626 | property@vmh.co.uk



33

GOGARLOCH SYKE

Forming part of a leafy cul-de-sac development in South Gyle, this mid-terraced house enjoys two double bedrooms with built-in wardrobes, a living/dining room, an attractive kitchen, and a bathroom, and is presented in a move-in condition with modern, neutral interiors. The home is accompanied by a well-maintained, south-facing garden and an allocated parking space.

Features

- Mid-terraced house in South Gyle
- Part of a leafy, cul-de-sac development
- Modern, neutral interiors
- Entrance porch
- Elegant living/dining room
- Attractive, timeless kitchen
- Two double bedrooms with built-in wardrobes
- Bathroom with shower-over-bath
- South-facing, well-maintained garden
- Allocated parking space
- Gas central heating and double glazing



"...Mid-terraced house in South Gyle, part of a leafy, cul-de-sac development..."



EPC Rating - C

Home Report Value - £235,000

For up to date price & viewing information contact VMH Property or visit us online.



Extras: all fitted floor coverings, window coverings, light fittings, and integrated kitchen appliances will be included in the sale.

Ground Floor
Approx. 28.8 sq. metres (310.0 sq. feet)

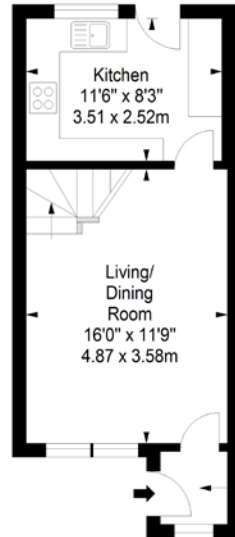

First Floor
Approx. 27.3 sq. metres (293.9 sq. feet)

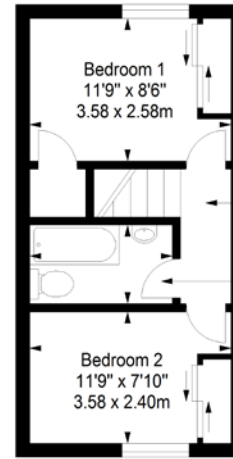

Shed
Approx. 2.1 sq. metres (22.6 sq. feet)



Landing

Bathroom
8'7" x 4'6"
2.61 x 1.38m



Total area: approx. 58.2 sq. metres (626.5 sq. feet)



VMH SOLICITORS

WWW.VMH.CO.UK

Registered Office: 8 Sibbald Walk, Edinburgh, EH8 8FT

T: 0131 622 2626 F: 0131 622 26267 E: property@vmh.co.uk

DX: 552210, Edinburgh 68



The dimensions provided are for illustration purposes only; detailed measurements should be taken personally. No documentation will be exhibited in respect of the compliance or otherwise of replacement windows. Although every attempt has been taken to ensure accuracy, the details within the brochure are not guaranteed or warranted and will not form part of any future contract to buy.