



GILSON GRAY

LAW • PROPERTY • FINANCE

129 TWEEDSMUIR DRIVE

Little France, Edinburgh, EH16 4XU



Nestled at the end of a cul-de-sac by open parkland, this contemporary, three-bedroom, end-terrace house forms part of a sought-after development in popular Little France. The southwest-facing property enjoys bright neutral interiors throughout and quality fixtures and fittings, including a fashionable kitchen/dining room with a generous footprint and access to the rear garden. The garden itself is landscaped and fully enclosed, providing a family-friendly space with a neat lawn and a dining deck.

Extras: all fitted floor and window coverings, light fixtures, integrated appliances (oven, gas hob, and fridge/freezer), a dishwasher, and a washing machine to be included in the sale. Please note, no warranties or guarantees shall be provided in relation to any of the services, moveables, and/or appliances included in the price, as these items are to be left in a sold as seen condition.

FEATURES

- Contemporary end-terrace house
- Part of a sought-after development
- Cul-de-sac setting in Little France
- Welcoming entrance hall
- Living room with French doors
- Large kitchen/dining room
- Two double bedrooms
- One versatile single bedroom
- Convenient ground-floor WC
- Quality en-suite shower room
- Three-piece family bathroom
- Good storage available (including a floored loft)
- Private front and rear gardens
- Allocated parking space
- EPC Rating - C
- Council Tax Band - E





“CUL-DE-SAC SETTING IN
LITTLE FRANCE WITH TWO
DOUBLE BEDROOMS
AND ONE VERSATILE
SINGLE BEDROOM”



EDINBURGH

29 Rutland Square
EH1 2BW
0131 516 5366

GLASGOW

160 West George Street
G2 2HQ
0141 530 2021

EAST LOTHIAN

33 Westgate
EH39 4AG
01620 893 481

DUNDEE

11 South Tay Street
DD1 1NU
01382 201 000

BORDERS

01890 880 008

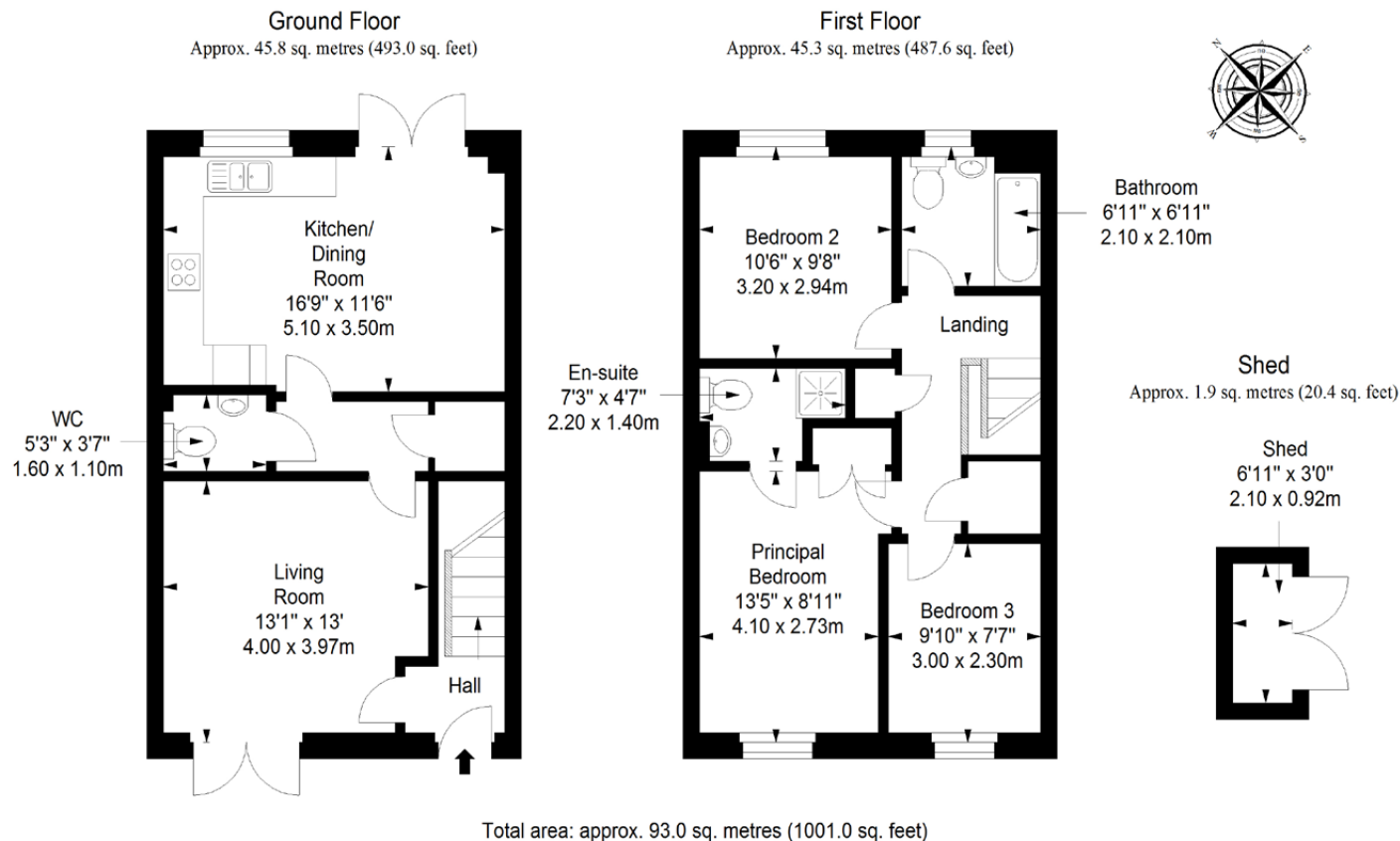

 @gilsongrayprop
  gilson gray property
  gilson gray property
  @gilsongrayprop



