



GILSON GRAY

LAW • PROPERTY • FINANCE

7 HEATHFIELD WYND

Dundee, DD3 9UB



Situated on a quiet cul-de-sac framed by mature trees, this three-bedroom detached house forms part of a modern development with a picturesque setting on the fringes of Dundee, yet still within easy reach of transport links and amenities. It features elegant interior design throughout and spacious living accommodation; plus, it has the benefit of two shower rooms (and a WC). The south-facing home also comes with generous private parking and a fully-enclosed rear garden.

Extras: all fitted floor and window coverings, light fixtures, integrated appliances (double oven, gas hob, fridge/freezer, and dishwasher), and a tumble drier to be included in the sale. Please note, no warranties or guarantees shall be provided in relation to any of the services, moveables, and/or appliances included in the price, as these items are to be left in a sold as seen condition.

FEATURES

- Modern detached house
- Part of a sought-after development
- Set by a local golf course in Dundee
- Bright, south-facing aspect
- Welcoming entrance hall
- Open-plan living and dining room
- Breakfasting kitchen and a utility room
- Three versatile bedrooms
- Convenient ground-floor WC
- Quality en-suite shower room
- Tiled family shower room
- Landscaped front and rear gardens
- Integrated garage and tandem driveway
- EPC Rating – C
- Council Tax Band – D







"CONVENIENT GROUND-FLOOR
WC, QUALITY EN-SUITE SHOWER
ROOM AND A TILED FAMILY
SHOWER ROOM"





FLOORPLAN

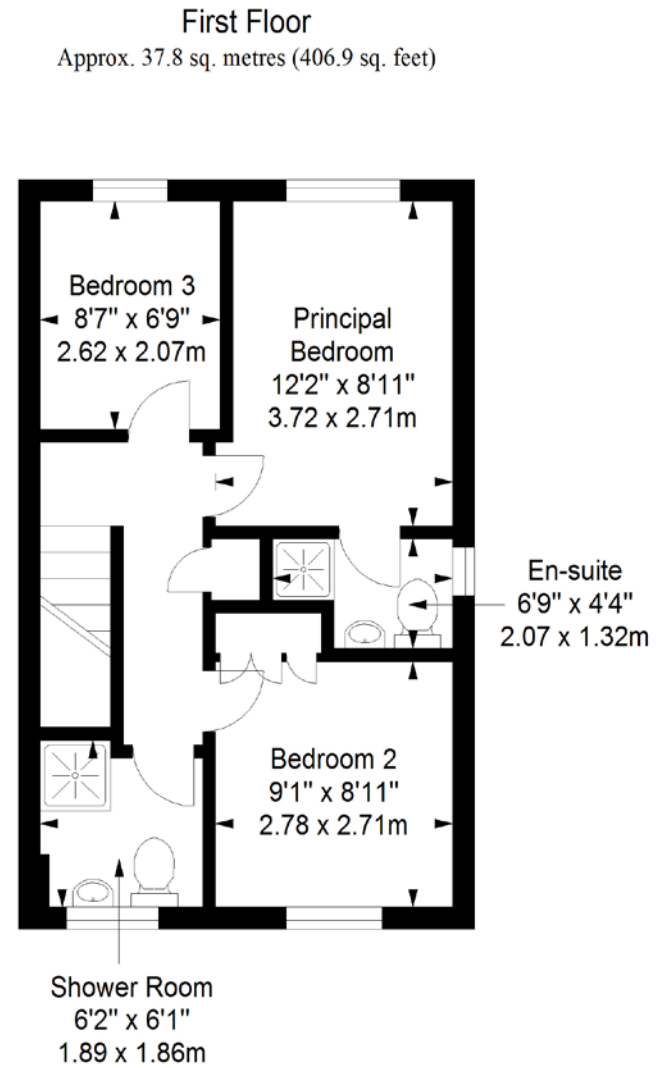
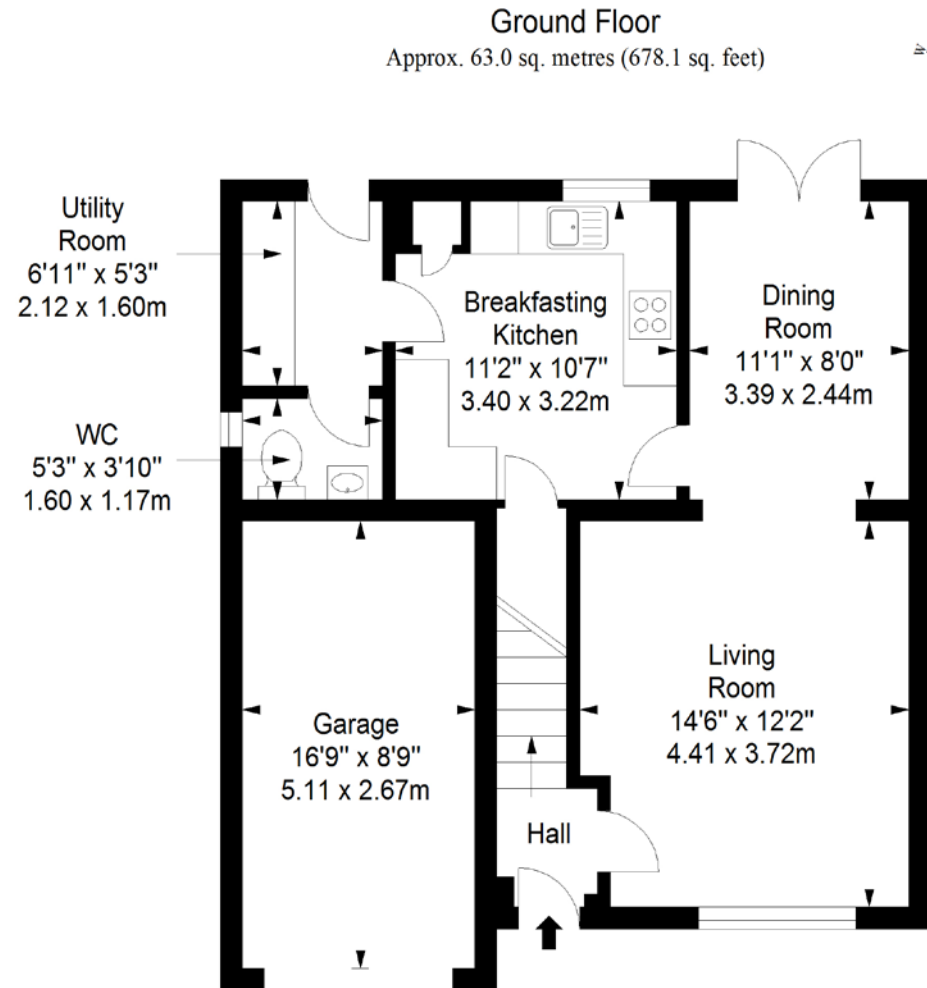

Total area: approx. 100.8 sq. metres (1085.0 sq. feet)



GILSONGRAY.CO.UK

EDINBURGH

29 Rutland Square
EH1 2BW
0131 516 5366



GLASGOW

160 West George Street
G2 2HQ
0141 530 2021



EAST LOTHIAN

33 Westgate
EH39 4AG
01620 893 481



DUNDEE

11 South Tay Street
DD1 1NU
01382 201 000



BORDERS

01890 880 008



@gilsongrayprop



gilson gray property



gilson gray property



@gilsongrayprop

These particulars were prepared on the basis of our own knowledge of the local area and, in respect of the property itself, information supplied to us by our clients; all reasonable steps were taken at the time of preparing these particulars to ensure that all details contained in them were accurate. All statements contained in the particulars are for information only and all parties should not rely upon them as statements or representations of fact. In particular, (a) descriptions, measurements and dimensions, which may be quoted in these particulars are approximate only and (b) all references to conditions, planning permission, services, usage, constructions, fixtures and fittings and movable items contained in the property are for guidance only. Our clients may instruct us to set a closing date for offers at short notice and therefore if you wish to pursue interest in this property, you should immediately instruct your solicitor to note interest with us. Our clients reserve the right to conclude a bargain for the sale of the above subjects or any part thereof ahead of a notified closing date and will not be obliged to accept either the highest or indeed any offer for the above subjects or any part thereof. All measurements have been taken using a sonic tape and cannot be regarded as guaranteed given the limitations of the device. Services and/or appliances referred to in these particulars have not been tested and no warranty is given that they are in full working order.