



## 11 Avondale Place

Stockbridge, Edinburgh, EH3 5HX

*We sell homes, not just houses*





## Summary

*This B-listed, main-door, ground-floor flat is a one-bedroom residence that forms part of the sought-after Stockbridge Colonies, offering a semi-rural ambience in easy reach of award-winning amenities, transport links, and Edinburgh city centre. The home is well presented throughout in light neutral tones and it is fitted with a modern kitchen and shower room. It is sure to appeal to city professionals, downsizers, and couples alike.*

*Extras: all fitted floor and window coverings, light fittings, an integrated oven and gas hob, a freestanding fridge/freezer, and a washing machine to be included in the sale.*



---

## Features

- Well-presented ground-floor flat
- Part of a traditional B-listed building
- In the Stockbridge Colonies
- Private main-door entrance
- Vestibule and hall with storage
- Bright and airy living room
- Well-appointed kitchen
- Spacious double bedroom
- Modern three-piece shower room
- Low-maintenance front garden
- Controlled permit parking (Zone N2)
- Gas central heating system
- Traditional sash windows
- EPC Rating - C





“Private main-door entrance  
and a bright & airy living room”







“Spacious double bedroom  
and a modern three-piece  
shower room”





# Floorplan

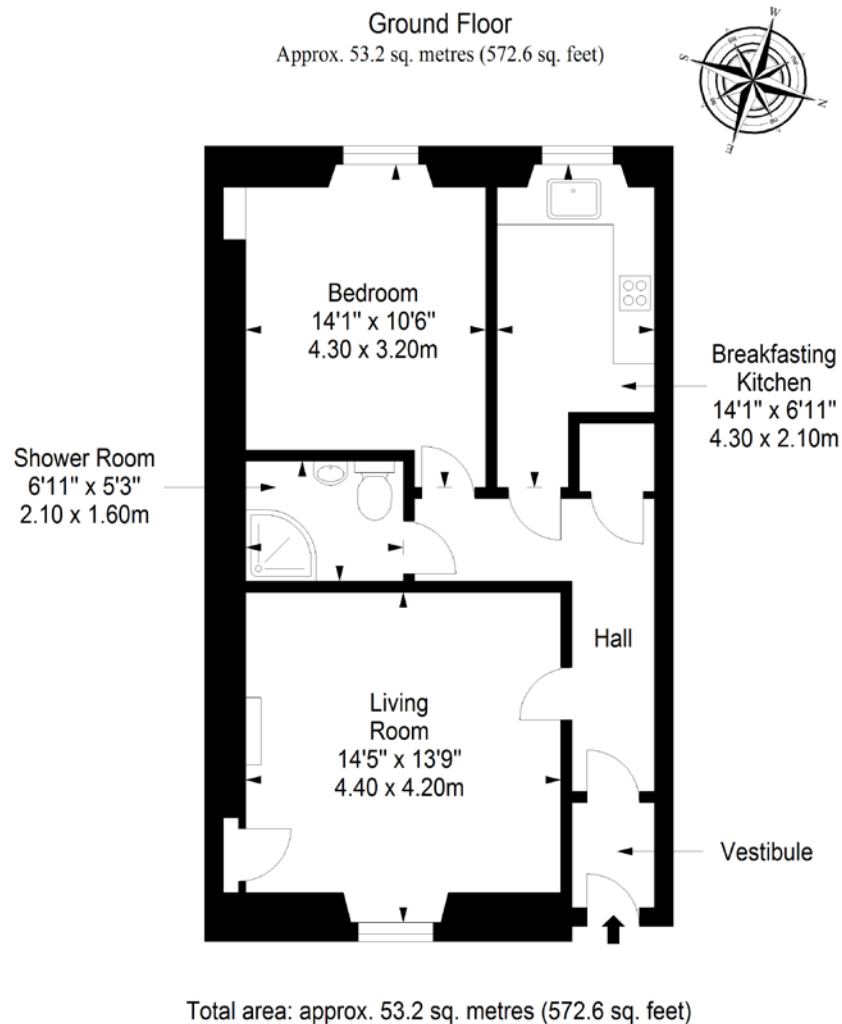

LEGAL OFFICE: 89-91 Morrison Street, Edinburgh, EH3 8BU  
0131 337 7771  
[www.clancys-solicitors.co.uk](http://www.clancys-solicitors.co.uk)

DISCLAIMER  
These particulars are intended to give a fair description of the property but their accuracy cannot be guaranteed, and they do not constitute or form part of an offer of contract. Intending purchasers must rely on their own inspection of the property. None of the above appliances/services have been tested by ourselves. We recommend purchasers arrange for a qualified person to check all appliances/services before legal commitment. Whilst every attempt has been made to ensure the accuracy of the floorplan contained here, measurements of doors, windows, rooms and any other items are approximate and no responsibility is taken for any error, omission, or misstatement. This plan is for illustrative purposes only and should be used as such by any prospective purchaser.

**CLANCYS**  
SOLICITORS & ESTATE AGENTS