



20 MEADOWPARK

HADDINGTON, EAST LoTHIAN, EH41 4DS



I PUBLIC



2 BED



I BATH



EPC
D



VMH SOLICITORS

0131 622 2626 | property@vmh.co.uk





Property Summary

This main-door lower flat forms part of a traditional terrace in Haddington and includes a double bedroom, a box bedroom, a living room, a kitchen, and a shower room, as well as offering exciting potential for its new owner to put their own stamp on it and create a modern home to suit their own tastes and requirements. The flat also benefits from a private garden area, access to a shared drying green, and unrestricted on-street parking.

Features

- Traditional, main-door lower flat in Haddington
- Excellent potential for modernisation
- Entrance vestibule and hall
- Spacious living room
- Sunny kitchen
- Southerly-facing double bedroom
- Good-sized box bedroom
- Shower room
- Private garden area
- Access to shared drying green
- Unrestricted on-street parking



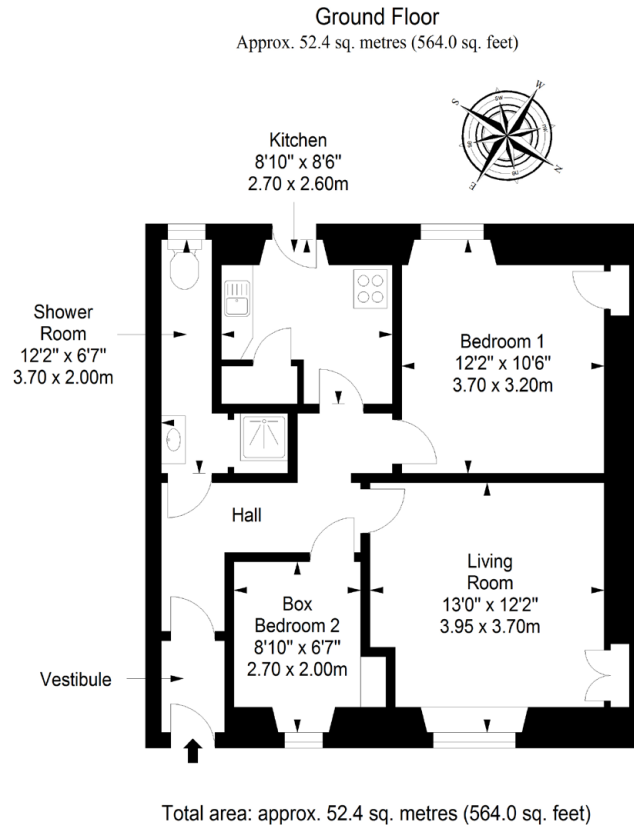

VMH SOLICITORS

WWW.VMH.CO.UK

Registered Office: 8 Sibbald Walk, Edinburgh, EH8 8FT

T: 0131 622 2626 F: 0131 622 26267 E: property@vmh.co.uk

DX: 552210, Edinburgh 68



CHARTERED FIRM