



43 WEST PRESTON STREET

NEWINGTON, EDINBURGH, EH8 9PY



I PUBLIC



I BED



I BATH



F



VMH SOLICITORS

0131 622 2626 | property@vmh.co.uk





Property Summary

Situated in bustling Newington, just a stone's throw from the Meadows, this unique one-bedroom main-door flat lies within a charming traditional tenement behind a former shop frontage, and enjoys tasteful contemporary interiors, an exceptionally bright open-plan living area and kitchen, one double bedroom with storage, and a shower room.

Features

- Enviable central location
- Attractive contemporary interiors
- Bright traditional main-door flat
- Entrance vestibule
- Open-plan living/dining area & stylish kitchen
- Sunny double bedroom with storage
- Modern en-suite shower room
- Controlled on-street parking (Zone 7)
- Electric heating



For up to date price & viewing information contact VMH Property or visit us online.

Ground Floor

Approx. 32.9 sq. metres (354.1 sq. feet)

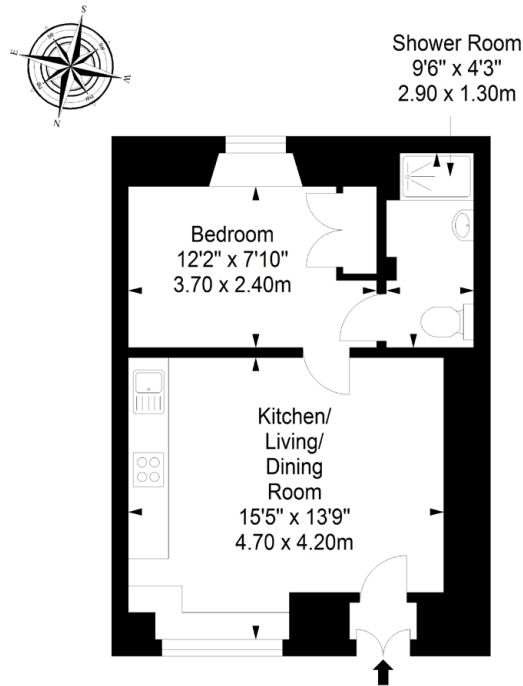

Total area: approx. 32.9 sq. metres (354.1 sq. feet)



VMH SOLICITORS

WWW.VMH.CO.UK

Registered Office: 8 Sibbald Walk, Edinburgh, EH8 8FT

T: 0131 622 2626 F: 0131 622 26267 E: property@vmh.co.uk

DX: 552210, Edinburgh 68



CHARTERED FIRM

The dimensions provided are for illustration purposes only; detailed measurements should be taken personally. No documentation will be exhibited in respect of the compliance or otherwise of replacement windows. Although every attempt has been taken to ensure accuracy, the details within the brochure are not guaranteed or warranted and will not form part of any future contract to buy.